



AMARILLO BI-CITY-COUNTY HEALTH DISTRICT
Amarillo, Canyon, Potter County, Randall County
CITY OF AMARILLO, P. O. Box 1971, Amarillo, TX, 79105-1971

Environmental Health Food Establishment Permitting Checklist

Completed application for a Permit to Operate a Food Establishment.	Yes <input type="checkbox"/>	No <input type="checkbox"/>
Completed Food Establishment Plan Review Guide.	Yes <input type="checkbox"/>	No <input type="checkbox"/>
Proposed Menu	Yes <input type="checkbox"/>	No <input type="checkbox"/>
Equipment Schedule (or manufacture cut sheets) *	Yes <input type="checkbox"/>	No <input type="checkbox"/>
Site Plan (showing all dimensions) *	Yes <input type="checkbox"/>	No <input type="checkbox"/>
Floor Plan (drawn to scale) *	Yes <input type="checkbox"/>	No <input type="checkbox"/>

* If Equipment Schedule, Site Plan and Floor Plans are not included in application they must have been submitted through Development Services and verified by an Environmental Health Specialist that there is a copy of these either on the "Q Drive" or on a "Micro Fiche".

Q Drive:

Micro Fiche

EH Specialist Signature: _____ Date: _____

These submittal documents have been received and verified by:

Administrative Specialist: _____ Date: _____

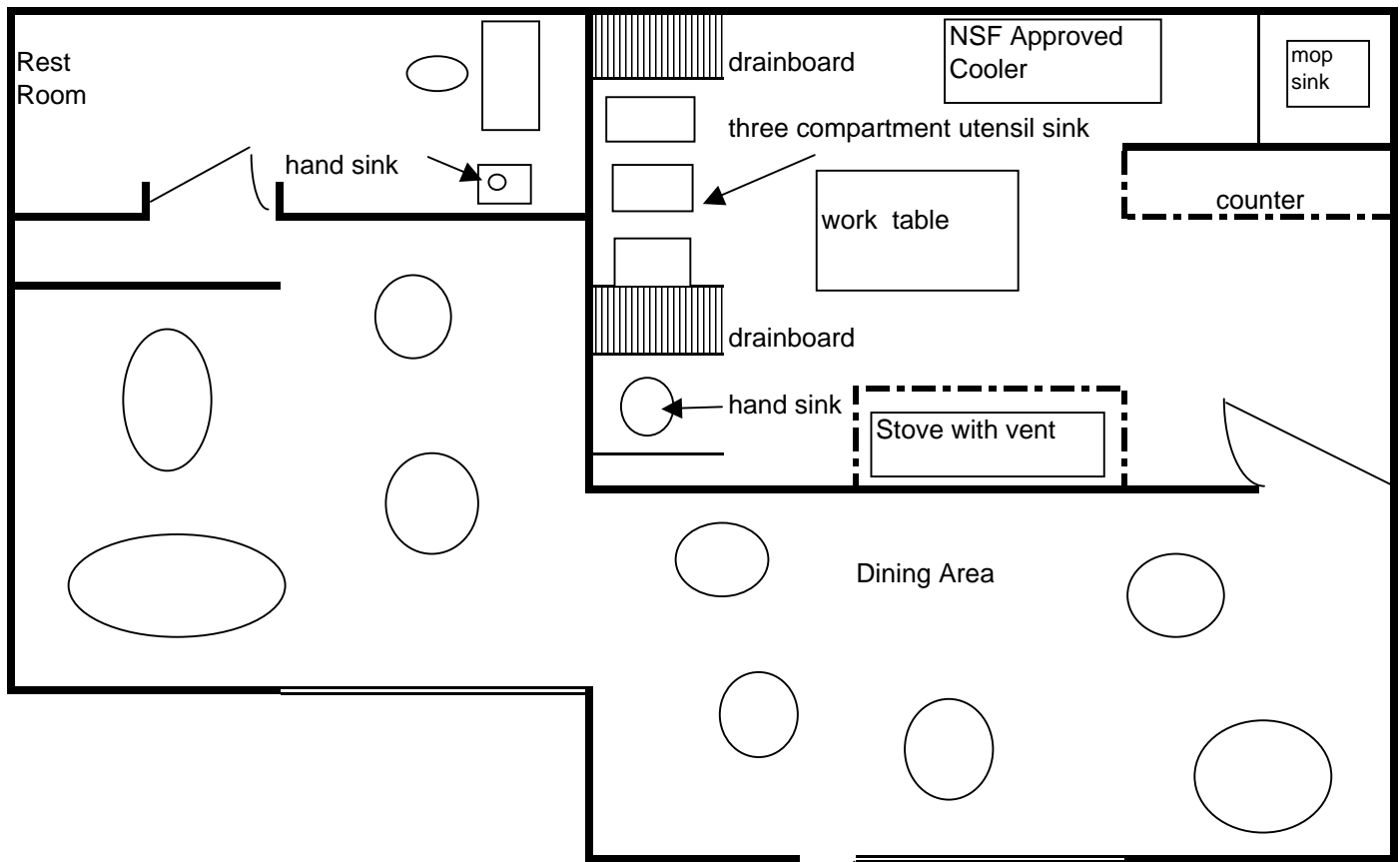

Establishment can be non smoking
 If smoking allowed, must designate
 areas for non smoking

Plot Plan

